



Ref: Agenda/Council-10/11/2020

9th November 2020

Dear Sir/Madam

All Members of the Town Council are hereby summoned to the **Council Meeting of Biggleswade Town Council** that will take place on **Tuesday 10th November 2020 via Virtual access, Biggleswade** commencing at **7.00 p.m.** in order to transact the under mentioned items of business.

Yours faithfully

Peter Tarrant
Town Clerk & Chief Executive

Distribution: All Town Councillors
Notice Board
Central Bedfordshire Council
The Editor, Biggleswade Today

Bedfordshire Constabulary
County Library, Biggleswade

SUPPLEMENTARY AGENDA

5. INVITED SPEAKER

Biggleswade Transport Interchange

To receive a presentation from Aziza Jeppe, Principal Highways Officer, Central Bedfordshire Council on the layout, current transport scheme design and high-level programme.

9. PLANNING APPLICATIONS

You can view details of applications and related documentation such as application forms, site plans, drawings, decision notices and other supporting documents for planning applications. Click on the hyperlink on the heading of each planning application listed below.

m. CB/20/03824/FULL- 7 & 11 Britten Place, Sullivan Court, Biggleswade

Conversion of commercial units (A2) to two residential dwellings.

12. ITEMS FOR INFORMATION

CB/TRE/20/00635 – 30 Ivel Gardens, Biggleswade, SG18 0AN

Works to Trees Protected by a Tree Preservation Order: MB/09/00002/T1 to fell or substantially reduce size of Sycamore Tree (T1).

13. EXEMPT ITEMS

The following resolution will be **moved** that is advisable in the public interest that the public and press are excluded whilst the following exempt item issue is discussed.

(14b. Biggleswade Town Council Mayors Christmas Dinner 4 December 2020)

Due to the current Covid-19 pandemic for Members to consider an alternative to the Biggleswade Town Council Mayors Christmas Dinner.

Pursuant to section 1(2) of the public bodies (Admission to Meetings) Act 1960 Council **resolve** to exclude the public and press by reason of the confidential nature of the business about to be transacted.

Biggleswade Transport Interchange

**Biggleswade Town Council
Tuesday 10th November 2020**

Biggleswade Transport Interchange proposal

Revision D of the General Arrangement for Biggleswade Interchange GRIP4 includes the following amendments:

- Short Footway Buildout on south side of Station Road
- Buildout widened and alignment change at the Station Car Park entrance (1 car park space reinstated)
- Buildout between Office Entrance and Car Park Entrance to delineate between the two areas and protect parked vehicles (Area to be low level vegetation)
- Removal of 30mph Zone and replaced with extended 20mph zone signage and roundels

The purpose of these amendments is to reduce vehicular speeds and improve safety along Station Road by narrowing the carriageway at a critical point to 6.4m and including fresh roundels and signage to reinforce the legal speeds in the area. This will result in a continuous 20mph zone from Biggleswade High Street and town centre through to the Interchange, creating an overall safer environment.

These amendments will also allow the previously lost carpark space within Network Rail carpark to be reinstated.

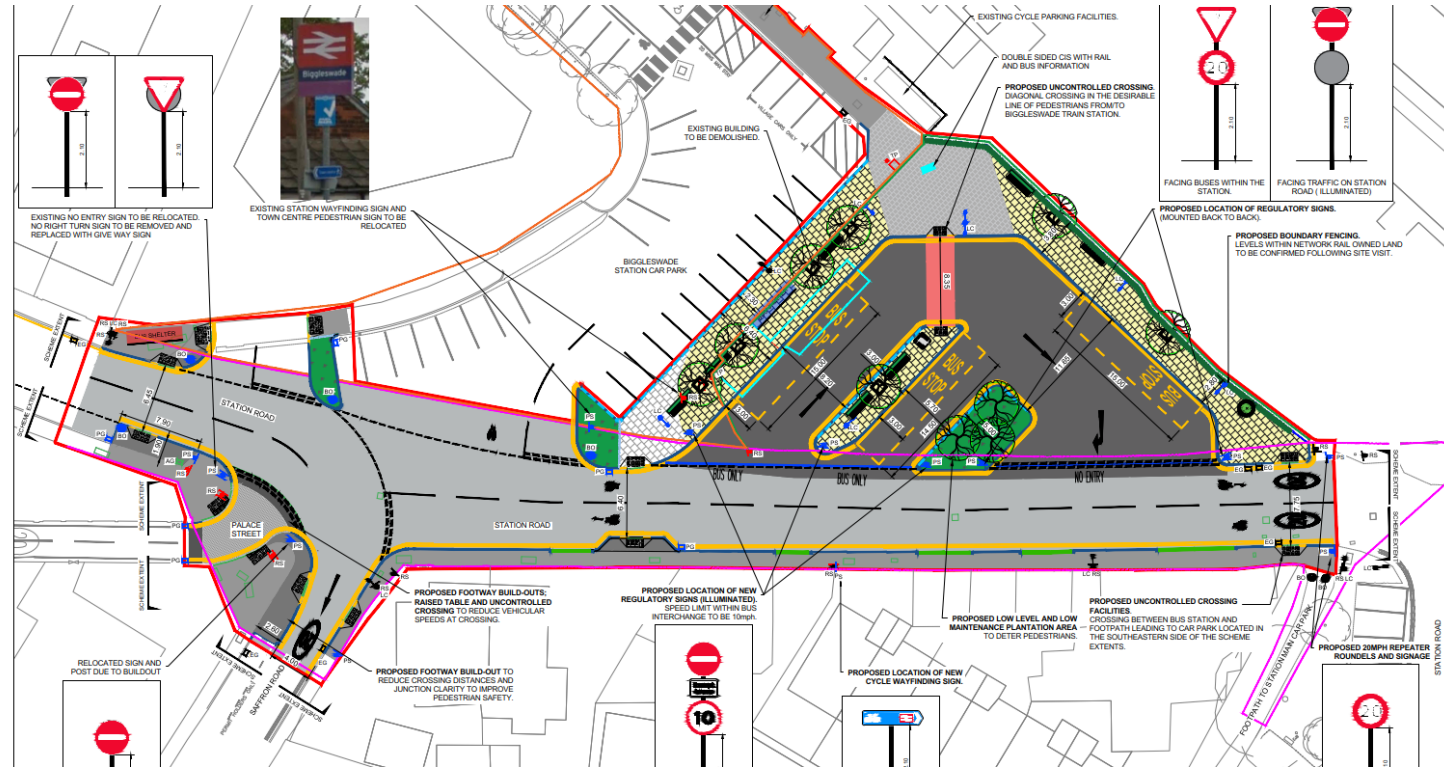

**VEHICLE TRACKING C -
BUS 2 ENTRY (5MPH)**

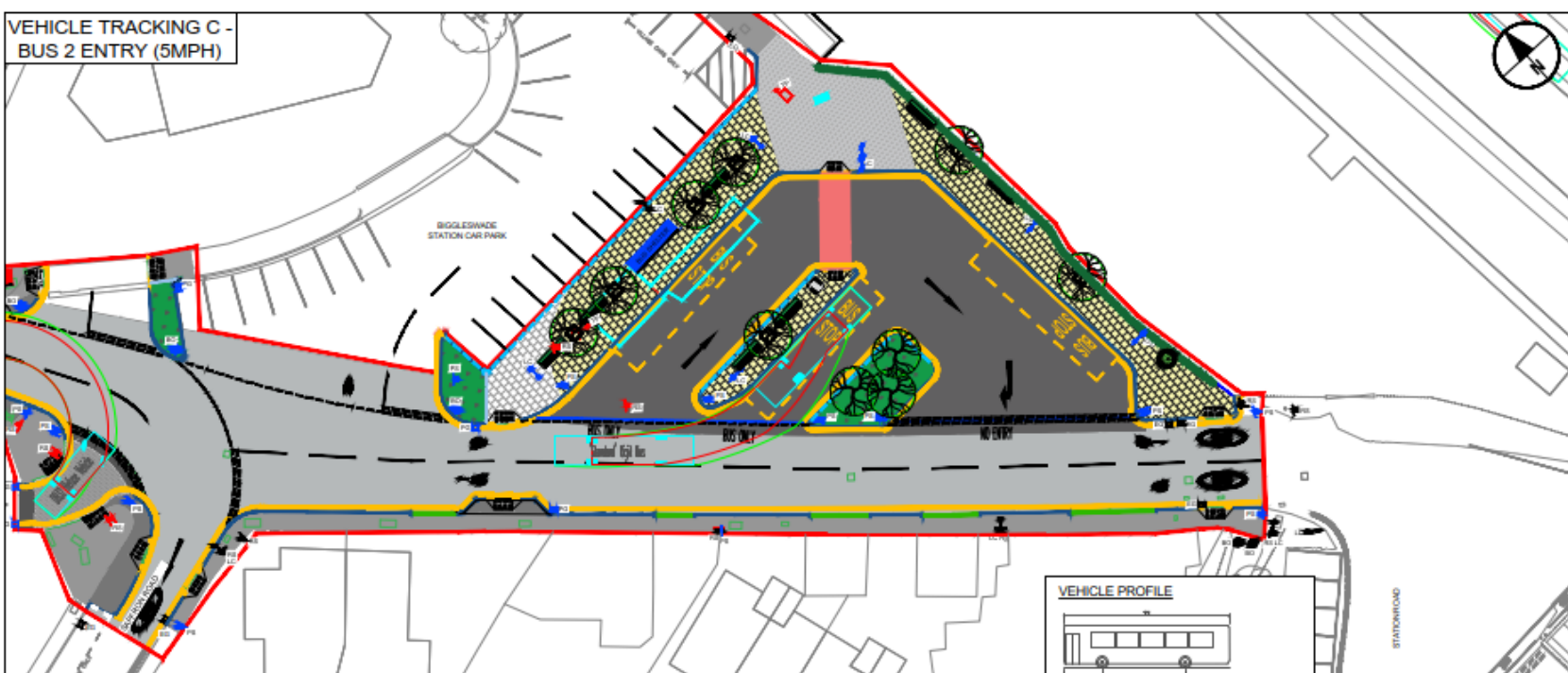

**VEHICLE TRACKING D -
BUS 2 EXIT (5MPH)**

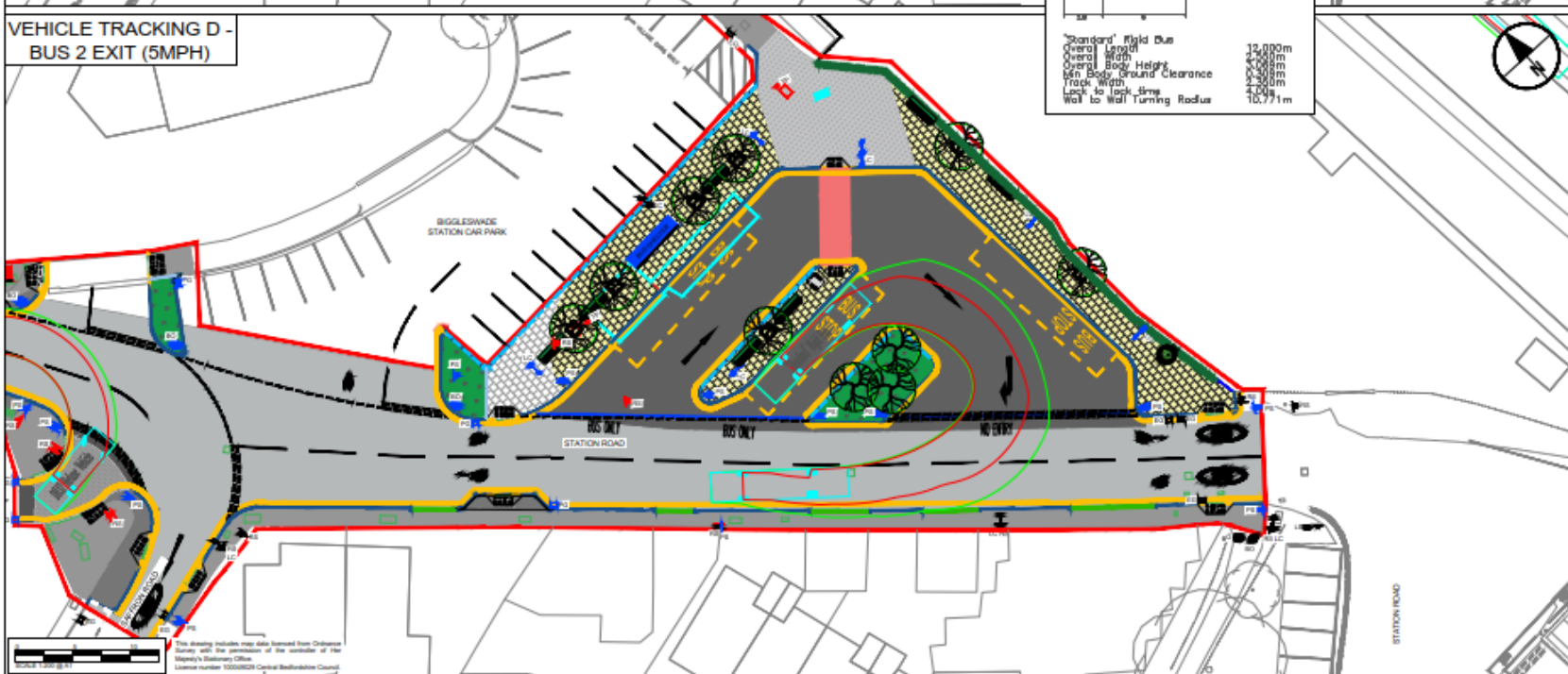

VEHICLE PROFILE

Standard Field Bus	12.000m
Overall Length	4.260m
Overall Width	2.500m
Overl Body Height	0.300m
Overl Body Ground Clearance	2.500m
Track Width	2.000m
Lack to lack time	4.000m
Wall to Wall Turning Radius	10.771m



PROJECT

Biggleswade Interchange
Outline Design

CLIENT



CONSULTANT

AECOM
Croydon
Sunley House CR0 2AP
+44(0)208.639.3500 tel
+44(0)208.639.3599 fax
www.aecom.com

NOTES

1. All dimensions are in metres unless otherwise stated. Do not scale from this drawing.
2. All items shown in grey are existing and are to remain unless stated otherwise.
3. The information shown on this drawing is based on topographical surveys undertaken by 'Premier Surveys' in November 2019.

ISSUE/REVISION

NO	DATE	DETAILS	DRN BY	CHKD BY	APRVD BY
B	12/10/20	THIRD ISSUE	AWM	AMC	ZZZ
A	18/05/20	SECOND ISSUE	AWM	YYY	ZZZ
G	13/12/19	FIRST ISSUE	ACC	SIA	KC

PROJECT NUMBER

60627006-B001

SHEET TITLE

Series 100 / Sheet 2 of 6
Vehicle Tracking

SHEET NUMBER

60627006-B001-100-02

**VEHICLE TRACKING E -
BUS 3 ENTRY (5MPH)**

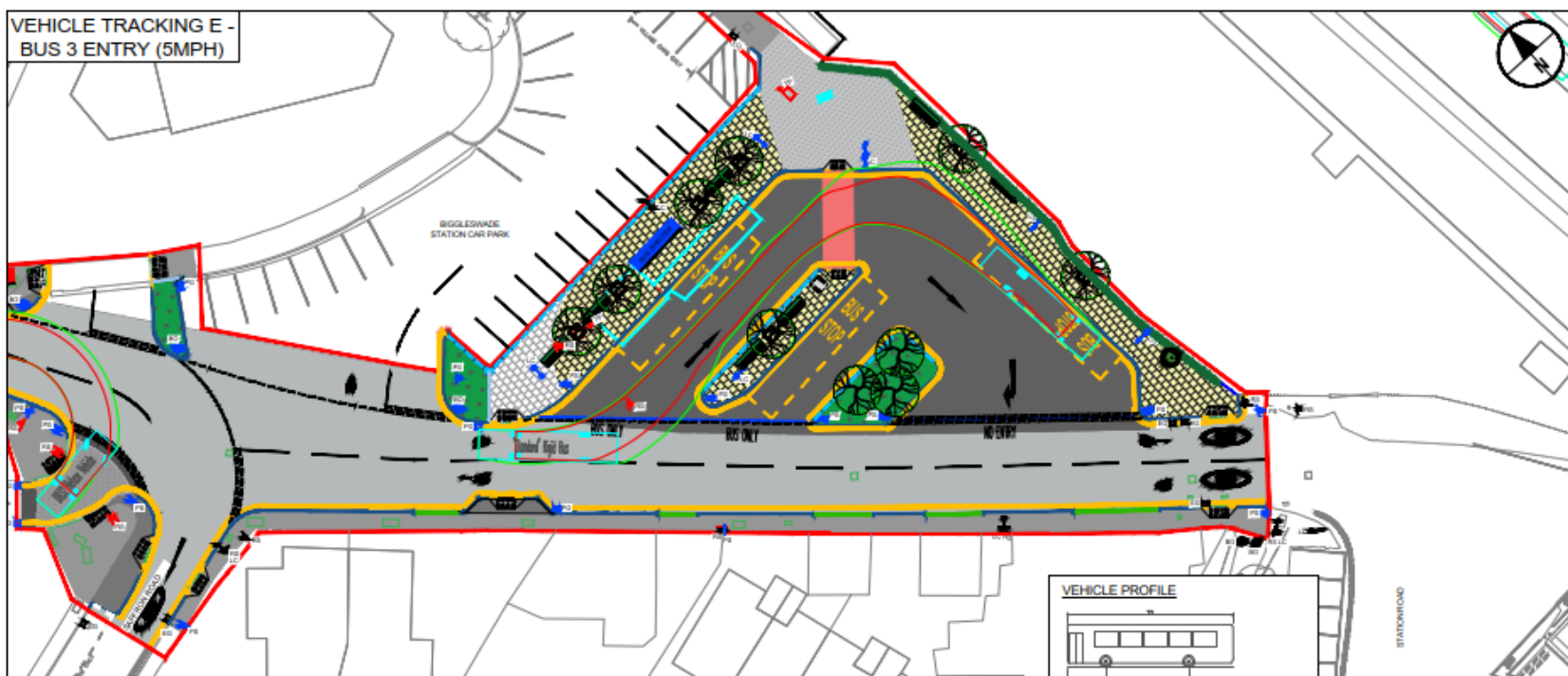

**VEHICLE TRACKING F -
BUS 3 EXIT (5MPH)**

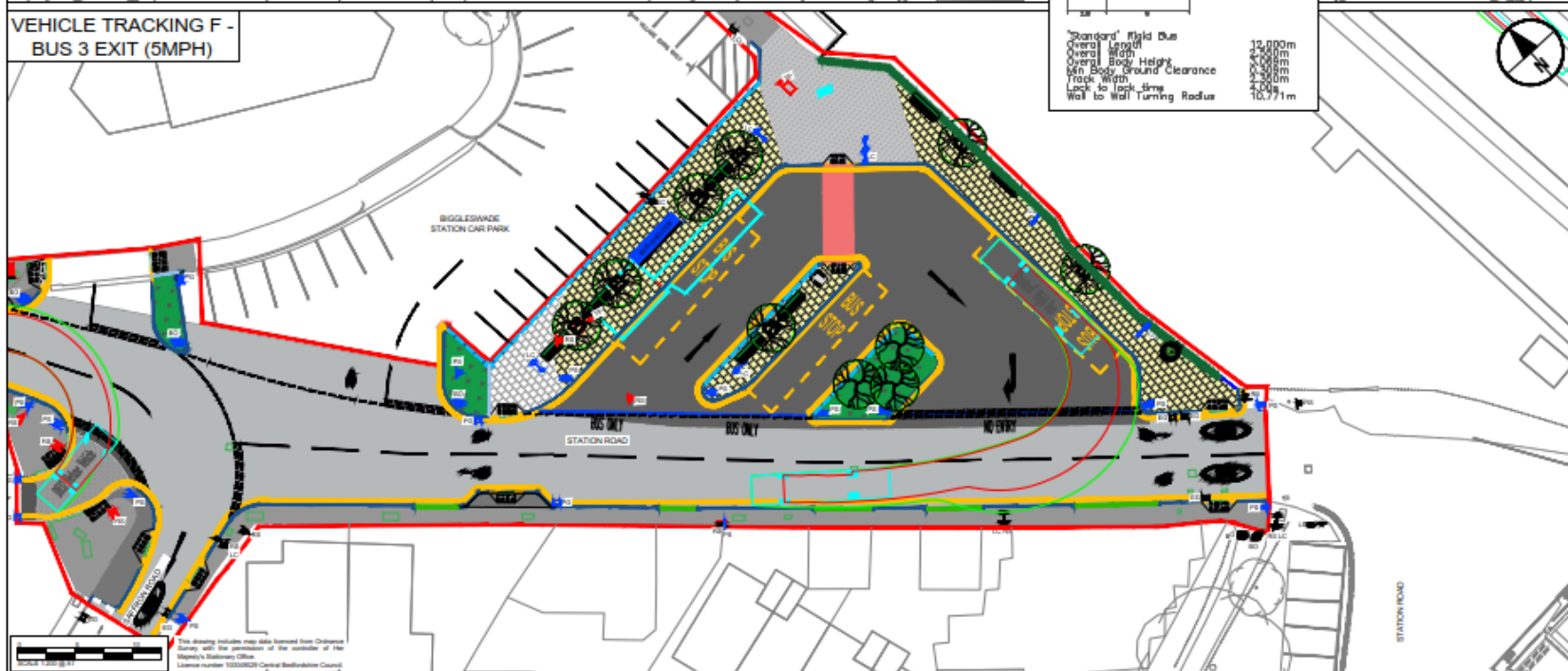

VEHICLE PROFILE

"Standard" rigid bus	12,000m
Overall Length	12,000m
Overall Width	2,500m
Overall Body Height	3,100m
Min Body Ground Clearance	100mm
Track Width	2,300m
Lock to lock, tyre	2,000m
Wheel to Wheel Turning Radius	10,771m



PROJECT

**Biggleswade
Interchange**
Outline Design

CLIENT



CONSULTANT

AECOM
Croydon
Sunley House CR0 2AP
+44(0)208.639.3500 tel
+44(0)208.639.3599 fax
www.aecom.com

NOTES

- All dimensions are in metres unless otherwise stated. Do not scale from this drawing.
- All items shown in grey are existing and are to remain unless stated otherwise.
- The information shown on this drawing is based on topographical surveys undertaken by 'Premier Surveys' in November 2019.

ISSUE/REVISION

IR	DATE	DETAILS	DRN BY	CHKD BY	APPRVD BY
B	12/10/20	THIRD ISSUE	AWM	AMC	ZZZ
A	18/05/20	SECOND ISSUE	AWM	YYY	ZZZ
0	13/12/19	FIRST ISSUE	ACC	SIA	KC

PROJECT NUMBER

60627006-B001

SHEET TITLE

Series 100 / Sheet 3 of 6
Vehicle Tracking

SHEET NUMBER

60627006-B001-100-03

VEHICLE TRACKING G -
WAITING BUS PASS
(5MPH)

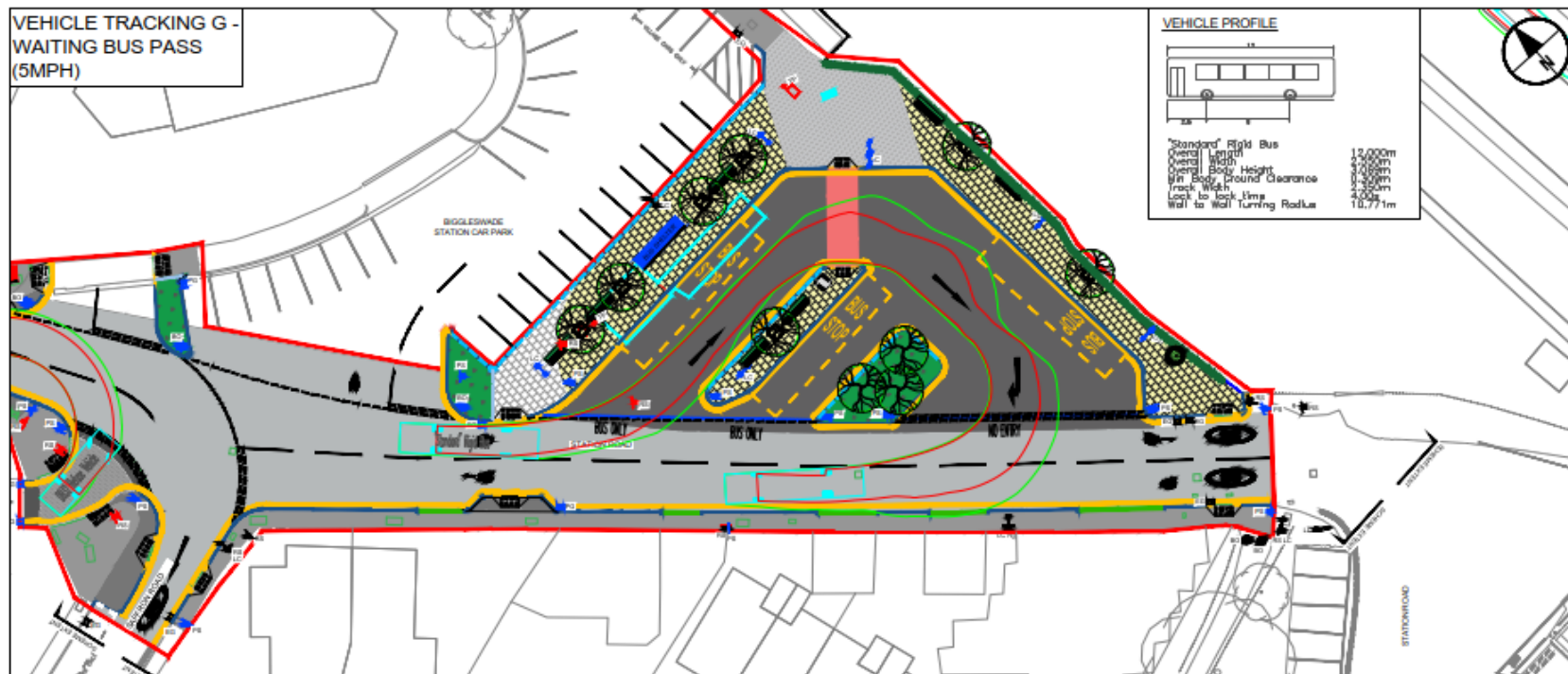

VEHICLE PROFILE

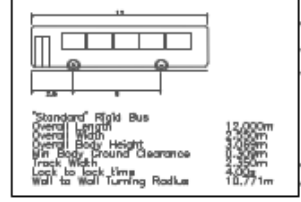

PROJECT

Biggleswade Interchange
Outline Design

CLIENT



CONSULTANT

AECOM
Croydon
Sunley House CR0 2AP
+44(0)208.639.3500 tel
+44(0)208.639.3599 fax
www.aecom.com

NOTES

- All dimensions are in metres unless otherwise stated. Do not scale from this drawing.
- All items shown in grey are existing and are to remain unless stated otherwise.
- The information shown on this drawing is based on topographical surveys undertaken by 'Premier Surveys' in November 2019.

VEHICLE TRACKING H -
WAITING BUS ENTRY
(5MPH)

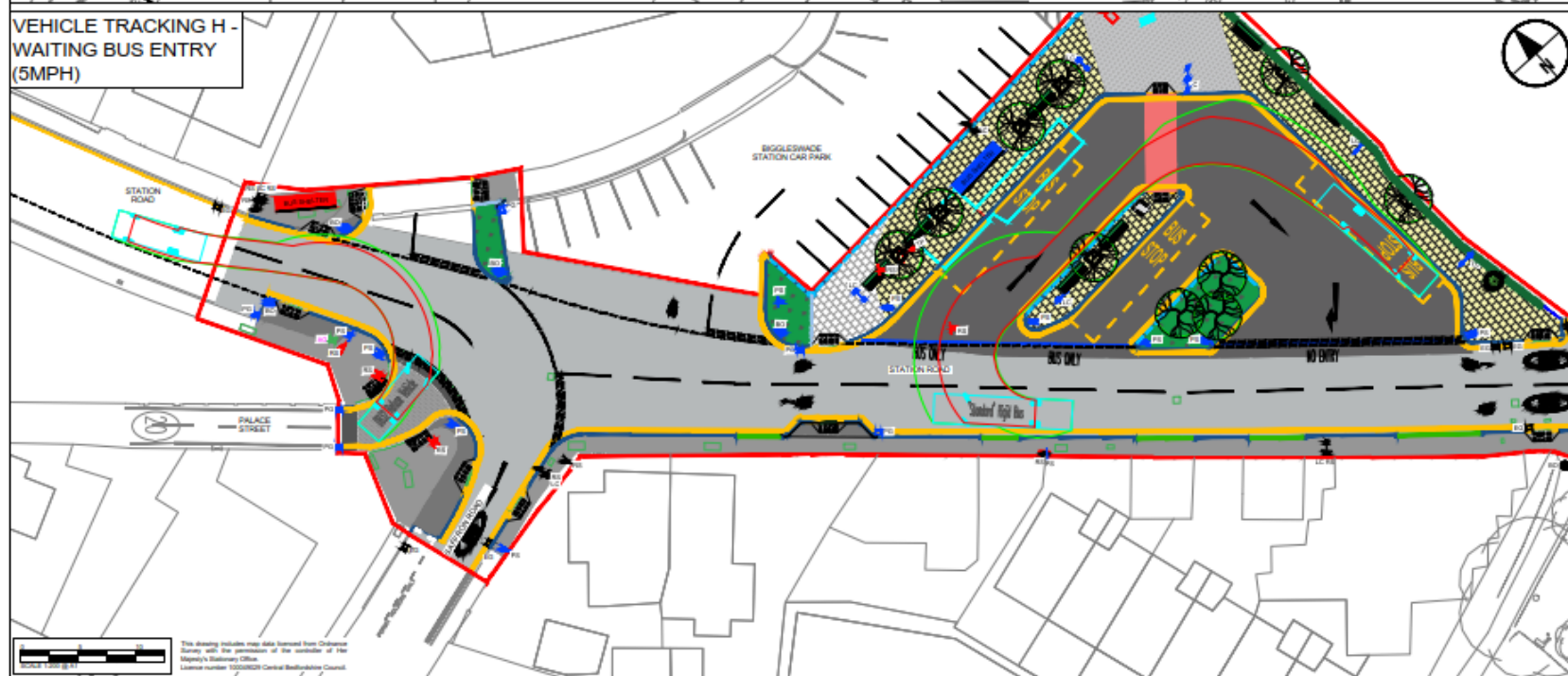

ISSUE/REVISION

REV	DATE	DETAILS	DRN BY	CHKD BY	APPRD BY
B	12/10/20	THIRD ISSUE	AWM	AMC	ZZZ
A	18/05/20	SECOND ISSUE	AWM	YYY	ZZZ
0	13/12/19	FIRST ISSUE	ACC	SIA	KC

PROJECT NUMBER

60627006-B001

SHEET TITLE

Series 100 / Sheet 4 of 6
Vehicle Tracking

SHEET NUMBER

60627006-B001-100-04

**VEHICLE TRACKING K -
REFUSE MOVEMENTS
(5MPH)**

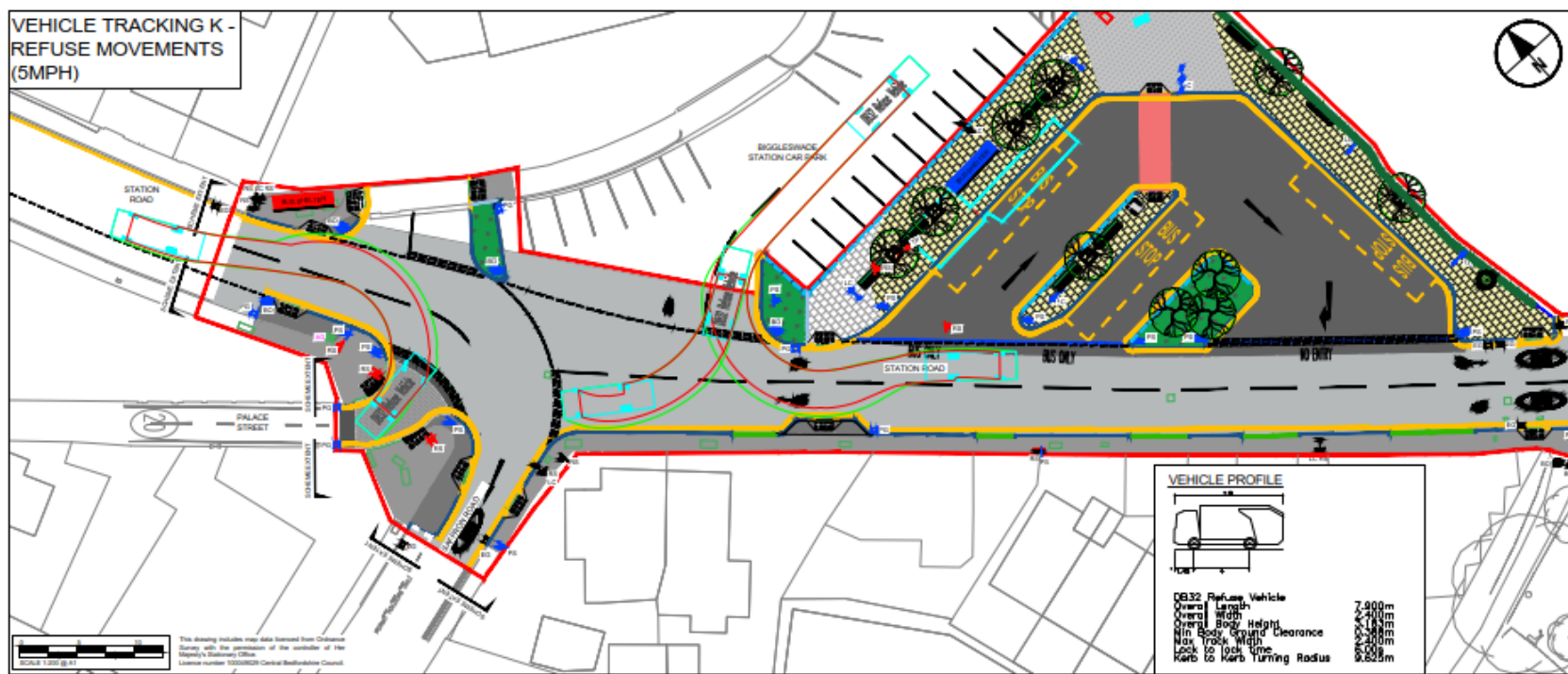

This drawing includes data taken from Ordnance Survey with the permission of the controller of the Mapping & Stationery Office. Licence number 100000020 Central Bedfordshire Council.

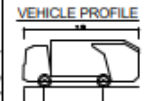

DB32 Refuse Vehicle	7.800m
Overall Length	7.800m
Overall Width	2.400m
Min Body Ground Clearance	0.300m
Max Track Width	2.400m
Lock to lock time	4.000m
Wall to Wall Turning Radius	9.800m

**VEHICLE TRACKING L -
BUS MOVEMENTS
(5MPH)**

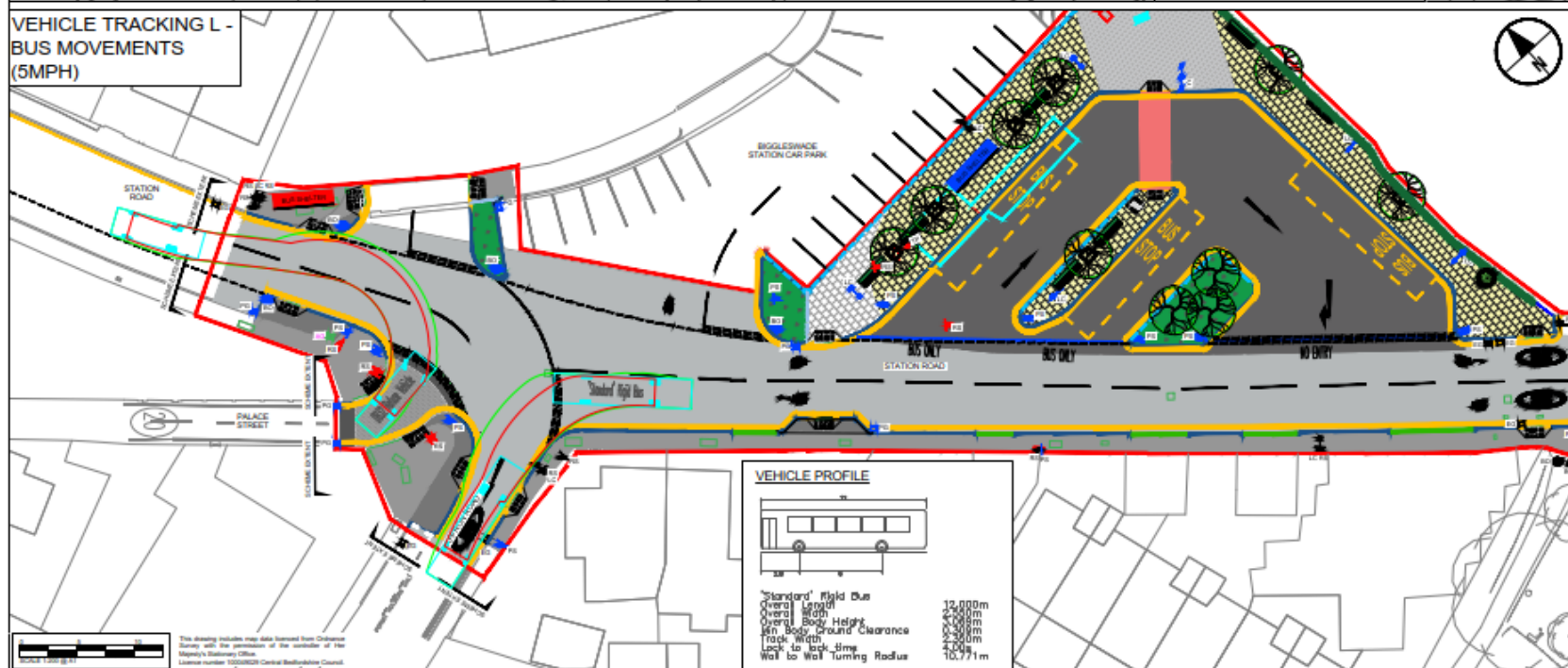

This drawing includes data taken from Ordnance Survey with the permission of the controller of the Mapping & Stationery Office. Licence number 100000020 Central Bedfordshire Council.

VEHICLE PROFILE

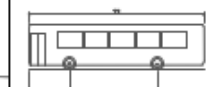

Standard Hybrid Bus	12.000m
Overall Length	12.000m
Overall Width	2.700m
Min Body Ground Clearance	0.300m
Track Width	2.700m
Lock to lock time	4.000m
Wall to Wall Turning Radius	10.771m



PROJECT

Biggleswade Interchange
Outline Design

CLIENT



CONSULTANT

AECOM
Croydon
Sunley House CR0 2AP
+44(0)208.639.3500 tel
+44(0)208.639.3599 fax
www.aecom.com

NOTES

- All dimensions are in metres unless otherwise stated. Do not scale from this drawing.
- All items shown in grey are existing and are to remain unless stated otherwise.
- The information shown on this drawing is based on topographical surveys undertaken by 'Premier Surveys' in November 2019.

ISSUE/REVISION

SR	DATE	DETAILS	DRN BY	CHKD BY	APPRD BY
B	12/10/20	THRD ISSUE	AWM	AMC	ZZZ
A	18/05/20	SECOND ISSUE	AWM	YYY	ZZZ
G	13/12/19	FIRST ISSUE	ACC	SIA	KC

PROJECT NUMBER

60627006-B001

SHEET TITLE

Series 100 / Sheet 6 of 6
Vehicle Tracking

SHEET NUMBER

60627006-B001-100-06

Immediate Programme Milestones

Milestone	Start	Finish
GRIP 4 Option Development Stage	24 February 2020	31 March 2021
Submission of Planning Application	1 December 2020	1 December 2020
CBC Planning Application Review	2 December 2020	19 February 2021
Planning Application Approval	8 March 2020	8 March 2020

End

Development Management

Central Bedfordshire Council

Priory House, Monks Walk
Chicksands, Shefford
Bedfordshire SG17 5TQ
www.centralbedfordshire.gov.uk



Mr Peter Tarrant
Clerk to Biggleswade Town Council
The Old Court House
4 Saffron Road
Biggleswade
Beds
SG18 8DL

Contact Pat Longland
Direct Dial 0300 300 4431
Email planning@centralbedfordshire.gov.uk
Your Ref
Date 09 November 2020

Dear Mr Tarrant,

Application No: CB/TRE/20/00635
Proposal: Works to Trees Protected by a Tree Preservation Order:
MB/09/00002/T1 to fell or substantially reduce size of Sycamore Tree
(T1).
Location: 30 Ivel Gardens, Biggleswade, SG18 0AN

I have received an application to carry out work to preserved tree(s) at the above property. You can view the application details and documents on our website by visiting:
<http://www.centralbedfordshire.gov.uk/tree-works-register>.

If you wish to comment on the application, please do so in writing by **30 November 2020** quoting the above application number.

All letters received are open to public view and therefore cannot be treated in confidence. Normally, your letter will not be acknowledged.

How coronavirus is affecting planning

We were already well prepared for agile working, operating a paper light planning application process. Most of our staff are now working from home, but can be contacted as normal via email or phone during working hours. A number of staff are working flexibly around childcare - please leave a message and they will get back to you as quickly as they can. We will of course be keeping staffing levels and workloads under constant review in light of any cases of self-isolation and childcare needs.

A small number of our planning admin team are in the office to register post, scan documents and print. However, as most applications can be registered remotely, please help us by making electronic submissions. Hard copy applications and postal comments are still being received, but there could be a delay in getting these logged as they have to be scanned in at the office. Please also be advised that we are unable to offer case history copies or other printing requests at this time.

We are continuing to consult on planning applications and consider any comments made. We will not be sending hard copy plans to parish and town councils in addition to electronic consultations. If you are unable to view plans then please contact the case officer to discuss.

Site visits by officers will only be carried out once the applicant / agent has first been contacted to discuss the suitability of a visit and whether arrangements can be made to

accord with up to date advice on social distancing. Case officers will then make a judgement as to whether a site visit can be made in a safe way – if this is not possible we will discuss the potential for alternative ways of assessing the site or in appropriate cases request your agreement that consideration of the application be paused.

In accordance with the latest advice on social distancing, we are unable to have face to face meetings, so we are asking customers not to come into our offices. Your case officer will contact you to discuss alternative arrangements which could be via phone call or video conferencing.

Read about our Development Management Committee for updates and information about meetings:

https://www.centralbedfordshire.gov.uk/info/31/meetings/219/development_management_committee_-_meetings_and_agendas.

All of these arrangements will be kept under review and we would like to thank you for your co-operation during these challenging times.

Yours sincerely,

Pat Longland
Trees & Landscape Officer